

Transitions® Vantage™ lenses: Surfacing and Edging Processing Guidelines

The following processing information was collected and developed by Transitions Optical and our laboratory partners in preparation for the Transitions® Vantage™ launch. Please note that you may encompass two different types of engraving marks while working with Transitions Vantage lenses: markings with “+” or “T.” Lenses with both the “+” and the “T” deliver the same performance – there is no difference between the two products with the exception of the alignment markings.

Transitions® Vantage™ lenses with “+” Alignment Markings

As with any lens that has polarization, it’s imperative that the lens be properly aligned in the frame so that the patient receives the maximum benefits of the polarization filter. Transitions Vantage lenses are no different. The lens has a set orientation that is denoted by a series of markings – see below:

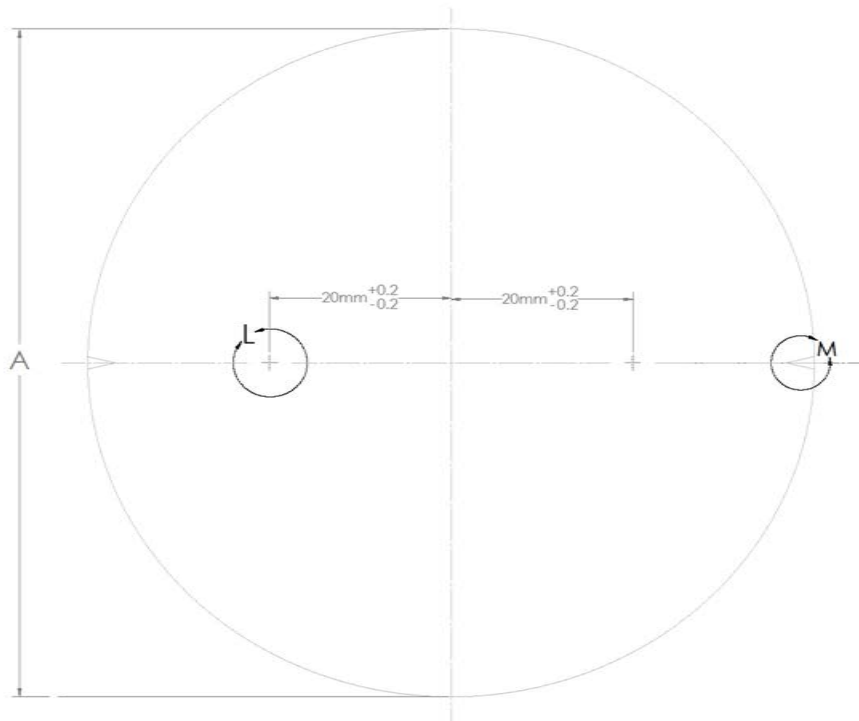

The polarization axis is denoted by the “>” and “<” at the edge of the lenses and the two “+” markings 20 mm off the center of the lens. The lens will be stamped to identify the horizontal (polarization) axis. The “>” and “<” markings are expected to be removed during the surfacing and edging process. The “+” are permanent markings that will most likely remain on the lenses.

Here are some general guidelines to use in surface blocking the lenses to ensure proper alignment of the Transitions Vantage lenses:

1. Place the lens on the blocker with the ">," "<" and "+" markings on the horizontal axis.
2. Block the lens on the optical center. If this is not possible due to required decentration, please be aware that the fitting crosses may migrate to the optical center.
3. Ensure that the markings are exactly on the 0-180 line with appropriate or tight tolerance .

Here are some general guidelines to use in finish blocking the lenses to ensure proper alignment of the Transitions Vantage lenses:

1. One or more of the ">," "<" and "+" markings on the horizontal axis may be cut off during surfacing.
2. For full backside products, use the engraved micro circles for alignment. DO NOT use a combination of engraved micro circles and the ">," "<" and "+" markings on the horizontal axis.
3. For non-full backside products, use the remaining ">," "<" and "+" markings on the horizontal axis. If all of the ">," "<" and "+" markings are missing from one side of the lens, spot the lens in a lensometer and use lensometer dots for alignment. Another option is to activate the lens and cross-polarize them with a piece of polarized film.

For eyecare professionals finishing an uncut lens in-office:

If you finish lenses at your office, surfaced uncuts of Transitions Vantage lenses will need to be processed carefully. Prior to edging, verify that the polarization axis and cylinder axis are aligned. Visit TransitionsVantage.com for a video tutorial.

To ensure that Transitions Vantage lenses have been mounted in the frame correctly, please follow the procedure below:

1. Hold the lenses up to a light, looking through them to find a "+" engraving marking on the nasal and temporal sides of the lenses. Dot the crosses with a marking pen. These lines should fall on a horizontal plane of a lens aligner.
2. In the event the markings are removed, you can determine the alignment of the lenses by cross-polarizing them with a piece a polarized film.
 - a. Activate the lenses in the Transitions lens UV demo lamp.
 - b. Hold the polarized film with the sticker facing you in the upper right hand side over the activated Transitions Vantage lenses.
 - c. Rotate the film 90 degrees so that the sticker facing you is in the lower right hand side. The lenses will look their darkest when the sticker is in the lower right hand corner and lightest when the sticker is in the upper right hand corner.

Transitions Vantage lenses with “T” Alignment Markings

The polarization axis is denoted by the “>” and “<” at the edge of the lenses and the two “T” marks located 20 mm off the center axis of the lens (see Figure 1). The lens will be stamped to identify the horizontal (polarization) axis. The “>” and “<” markings are expected to be removed during the edging process. The “T” marks are permanent markings that will most likely remain on the lenses.

To view the “T” marks, rotate the polarization axis into a vertical position (see Figure 2). Use typical methods for viewing progressive mold engravings to locate “T” markings. Once located, the “T” alignment marks can be identified by placing a dot with a pen over their location. When the lens is rotated back to the vertical position, the pen marks can aid in aligning the polarization axis during the dispensing process.

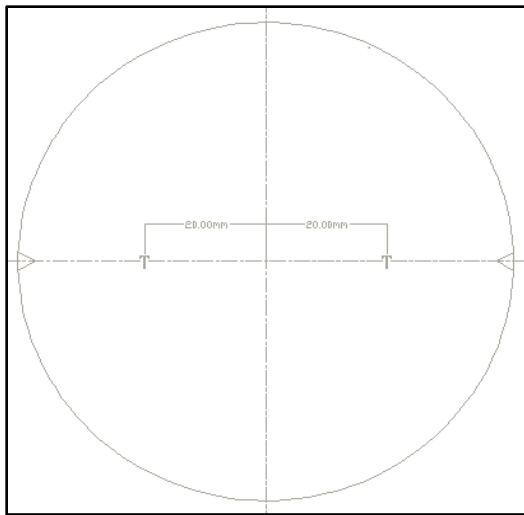

Figure 1

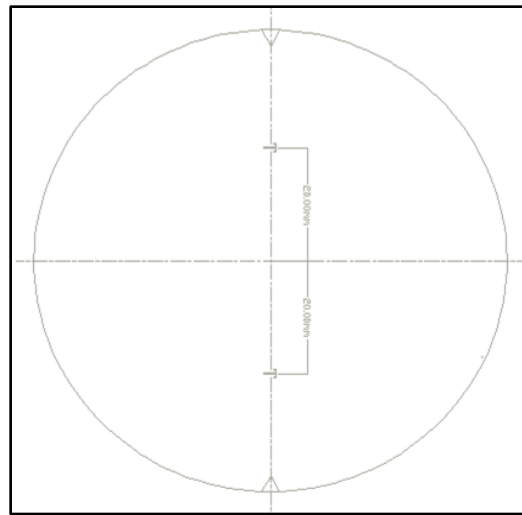

Figure 2

Here are some general guidelines to use in surface blocking the lenses to ensure proper alignment of the Transitions Vantage lenses:

1. Place the lens on the blocker with the “>,” “<” and “T” markings on the horizontal axis.
2. Block the lens on the optical center. If this is not possible due to required decentration, please be aware that the alignment “T”s may migrate to the optical center.
3. Take care that tight tolerance is employed to ensure that the lens is dead on at 180.

Here are some general guidelines to use in finish blocking the lenses to ensure proper alignment of the Transitions Vantage lenses:

1. One or more of the “>,” “<” and “T” markings on the horizontal axis may be cut off during surfacing.
2. For full backside products, use the engraved micro circles for alignment. DO NOT use a combination of engraved micro circles and the “>,” “<” and “T” markings on the horizontal axis.
3. For full backside products, use the remaining “>,” “<” and “T” markings on the horizontal axis. If all of the “>,” “<” and “T” markings are missing from one side of the lens, spot the lens in a lensometer and use lensometer dots for alignment. Another option is to activate the lens and cross-polarize them with a piece of polarized film.

For eyecare professionals finishing an uncut lens in-office:

If you finish lenses at your office, surfaced uncuts of Transitions Vantage lenses will need to be processed carefully. Prior to edging, verify that the polarization axis and cylinder axis are aligned. Visit TransitionsVantage.com for a video tutorial.

To ensure that Transitions Vantage lenses have been mounted in the frame correctly, please follow the procedure below:

1. Hold the lenses up to a light, looking through them to find a “T” engraving marking on the nasal and temporal sides of the lenses. Dot the crosses with a marking pen. These lines should fall on a horizontal plane of a lens aligner.
2. In the event the markings are removed, you can determine the alignment of the lenses by cross-polarizing them with a piece a polarized film.
 - a. Activate the lenses in the Transitions lens UV demo lamp.
 - b. Hold the polarized film with the sticker facing you in the upper right hand side over the activated Transitions Vantage lenses.
 - c. Rotate the film 90 degrees so that the sticker facing you is in the lower right hand side. The lenses will look their darkest when the sticker is in the lower right hand corner and lightest when the sticker is in the upper right hand corner.